

Feature

- Comply with RoHS requirements.
- Operating temperature range: 0°C to +70°C.
- Storage temperature range: -25°C to +105°C.

Electrical Specifications @ 25°C

OCL:	1.5mH Typ. (1.026-1.905mH) @100KHz/0.1V
Hi-Pot :	4400VAC 0.5mA 2S
Turns Ratio:	1:1.13 ±5%
DCR:	1.2ohm Max

Schematic

Mechanical

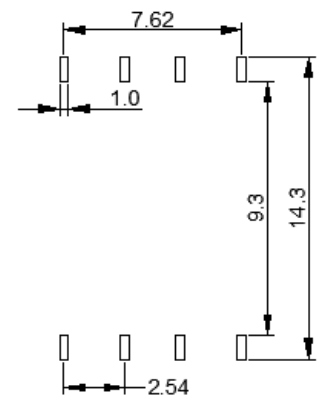
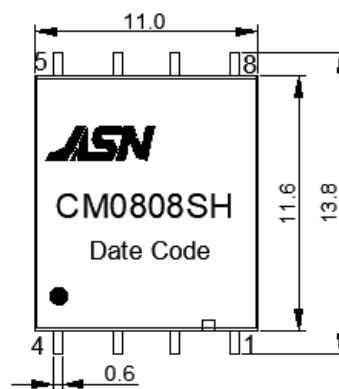
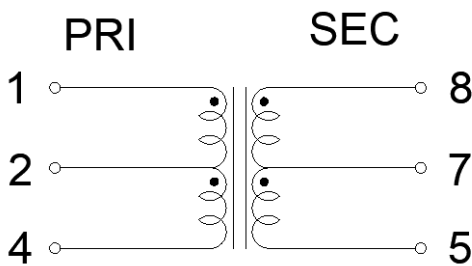

SUGGESTED PAD LAYOUT

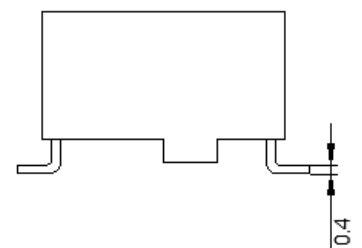
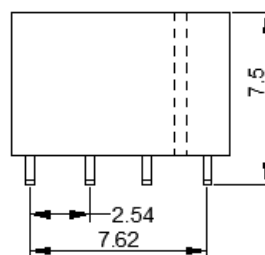

Unless otherwise specified, all tolerances are ±0.25mm